

311 255-02  
12.2025



**IMI TA**

# TA-Modulator

DN 40-50 (PN 25)

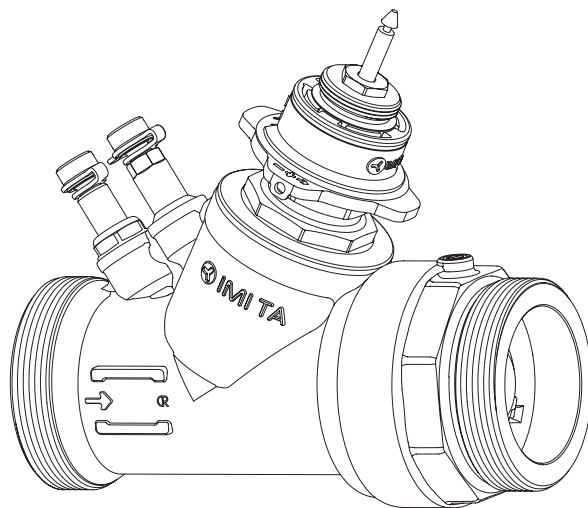

-10°C – +90°C (14°F – +194°F)

PN 25 (363 psi)

$\Delta pV_{max}$ : 600 kPa = 6 bar (87 psi)

$\Delta pV_{min}$ :  
 DN 40-50: 30 kPa = 0,30 bar (4.4 psi)  
 DN 50 HF: 40 kPa = 0,40 bar (5.8 psi)

HF = High flow

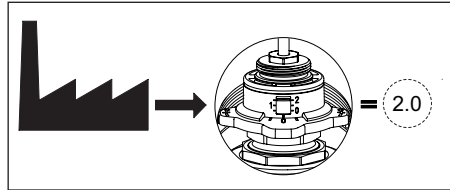

### TA-Slider 500

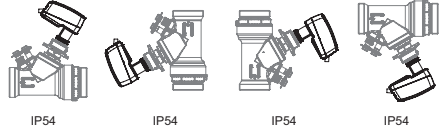

### TA-Modulator + TA-Slider 500

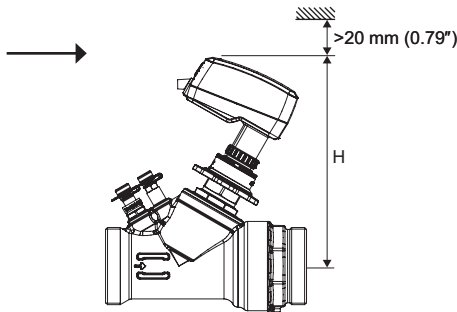

DN	H [mm]	
	TA-Slider 500	TA-Slider 500 Plus
40	203	212
50	206	215

Size	H [in]	
	TA-Slider 500	TA-Slider 500 Plus
1 1/2"	7.99	8.35
2"	8.11	8.46

Pos	$q_{max}$ [l/h]												
	0.8	0.9	1.0	1.1	1.2	1.3	1.4	1.5	1.6	1.7	1.8	1.9	2.0
DN 40	1000	1240	1530	1840	2200	2570	3020	3450	3960	4550	5200	5800	6500
DN 50	2150	2640	3220	3790	4430	5150	5990	6870	7800	8790	9740	10600	11200
DN 50 HF	5610	6440	7300	8180	9160	10300	11300	12400	13000	13600	14000	14400	14700

Pos	$q_{max}$ [gpm]												
	0.8	0.9	1.0	1.1	1.2	1.3	1.4	1.5	1.6	1.7	1.8	1.9	2.0
Size 1 1/2"	4.40	5.46	6.73	8.10	9.68	11.31	13.29	15.18	17.42	20.0	22.9	25.5	28.6
Size 2"	9.46	11.62	14.17	16.68	19.49	22.7	26.4	30.2	34.3	38.7	42.9	46.7	49.3
Size 2" HF	24.7	28.4	32.1	36.0	40.3	45.3	49.8	54.6	57.2	59.9	61.6	63.4	64.7

$q_{max}$  =

- l/h (US gpm) at each pre-setting and fully open valve plug.
- l/h bei der jeweiligen Voreinstellung und voll geöffnetem Regelkegel.
- l/h pour chaque pré réglage, la cône de la vanne étant complètement ouverte.
- l/h van elke voorinstelstand en volledig geopende afsluiterkegel.
- l/h para cada preajuste, estando el obturador en la posición totalmente abierta.
- l/h em cada posição de pré-ajuste e o disco da válvula totalmente aberto.
- l/h con ogni pre-impostazione e con la valvola completamente aperta.
- л/ч для каждой преднастройки и полностью открытым клапане.
- l/h az egyes előbeállításknál és teljesen nyitott szeleptányérnál.
- l/h dla każdej nastawy i w pełni otwartego trzpienia zaworu.

- l/h pro každý stupeň přednastavení při zcela otevřené regulační kuželce.
- l/hod pri danom prednastavení a plne otvorenej regulačnej kúželke.
- l/h pri dani prednastavitvi in popolnoma odprtem vretenu ventila.
- l/h pentru fiecare presetare si vana complet deschisa.
- l/h pri svakom prednamještanju i potpuno otvorenom ventilu.
- l/h на свакој пред-подешеној позицији и потпуно отвореном вентилу.
- l/h reguleerosa täiesti avatud asendis vastavalt eelseadearvule.
- l/h katram iepriekšiestatījumam un pilnībā atvērtam vārstam.
- l/h prie kiekvienos nustatymo padėties esant pilnai atidarytam vožtuvui.
- l/h vid respektive förinställning och fullt öppen ventilkägla.
- l/h ved angitt forinnstilling og fullt åpen ventilkjegle.
- l/h kyseisellä esisäätoarvoilla ventiliikara täysin auki.
- l/h ved respektiv forindstilling og fuldt åben ventilkjegle.

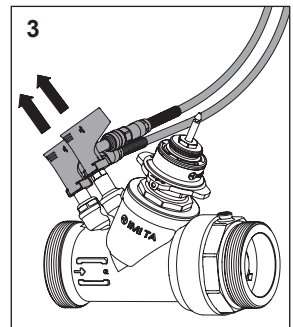
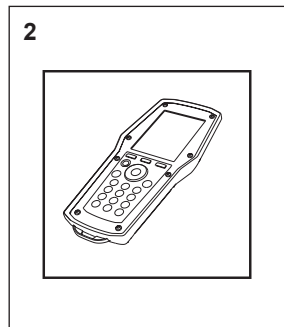
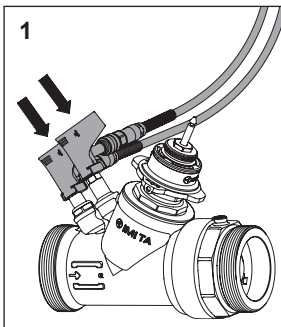
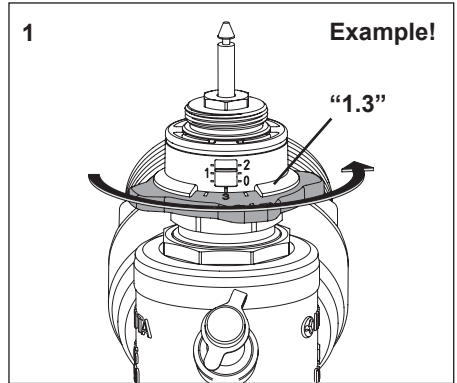
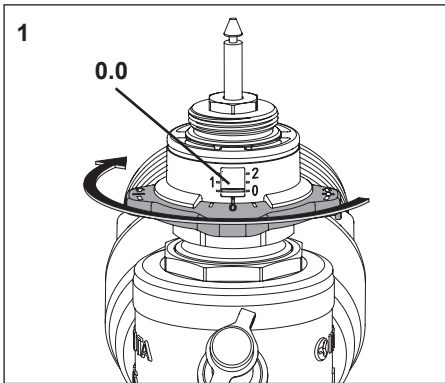
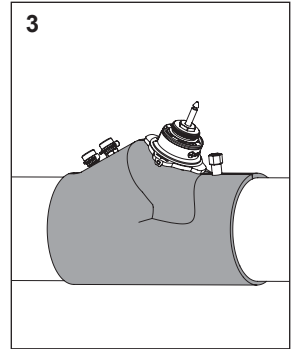
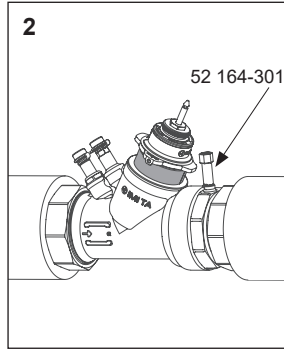
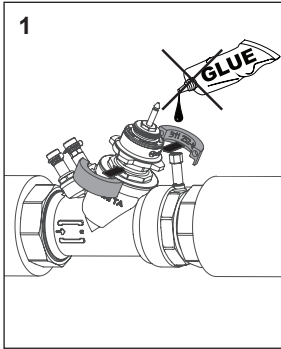

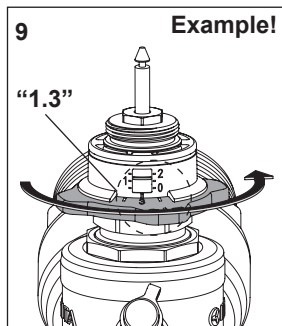
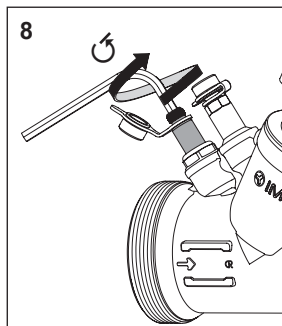
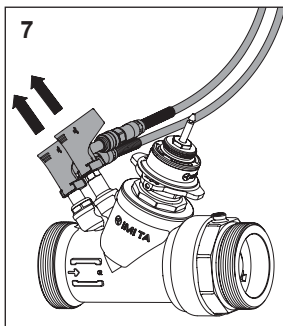
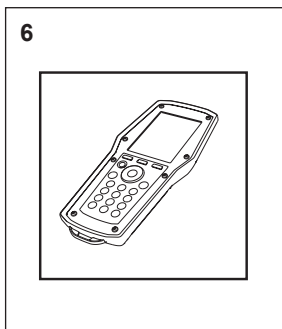
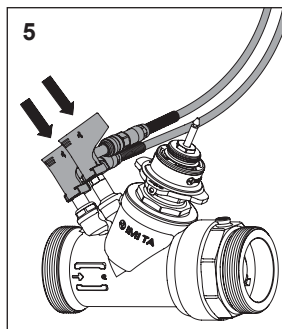
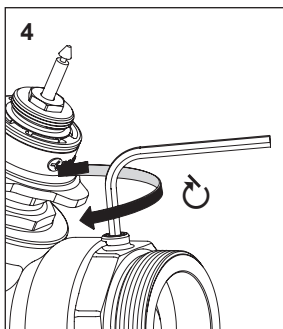
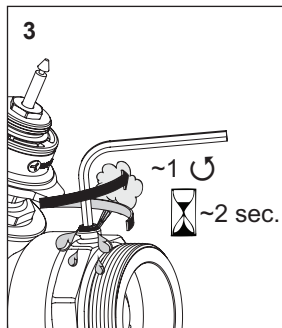
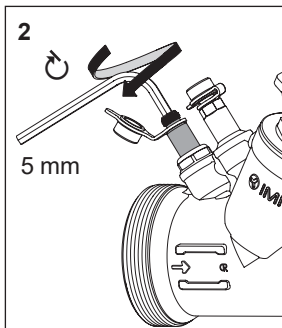
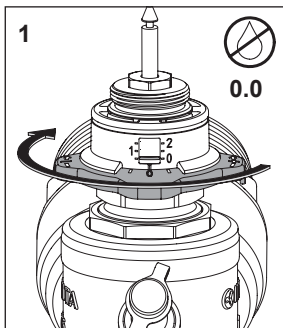

*We reserve the right to introduce technical alterations without prior notice.*

